

GENERAL TECHNICAL CHARACTERISTICS

- Dielectric : Polypropylene film
- Construction : Extended double side Metallized carrier film with internal series connection and Metallized film
- Case : Solvent resistant plastic case with resin sealing . Flame retardant execution (UL94V-0).
- Leads: Tinneaded insert M6 fillde with resin

ELECTRICAL CHARACTERISTICS

- Working teGperature : - 40 to + 85 °C
- Capacitance : 15 to 50μF
- Rated Voltage : 800Vdc
- Tolerance : ± 5%, ± 10%
- Dissipation factor: Measured at 1000±20 Hz AND 25±5°C.
When $C_r \leq 1.0\mu F$, 4×10^{-4} ;
When $C_r > 1.0\mu F$, 6×10^{-4}

Life expectancy: 100,000 hours at U_n and 70°C
(Hotspor temperature)



TEST METHDS AND PERFORGANCES

- Dielectric strength: 1.5Ur (DC) applied for 10s at 25±5°C (1 Gminute for type test)
- Insulation resistance : 3000s but need not exceed 30GΩ (typical value), after 1 Gminute of electrification at 100Vdc (25±5°C)

Outline drawing (结构: 全铝型与铝板+塑壳型)

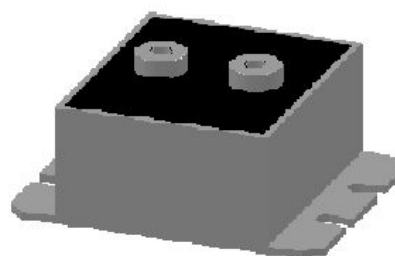
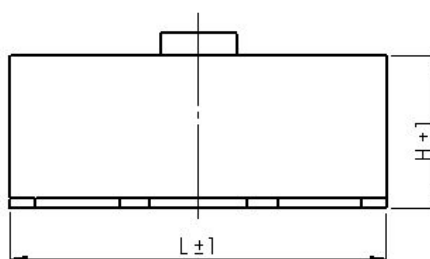
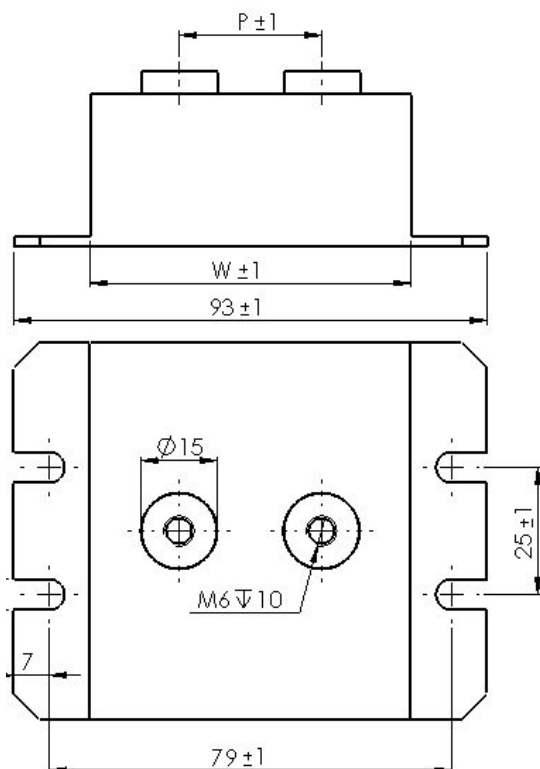

DAWNCAP DHC

Article table/参数表 Terminals : nut

Part Number	Capacitance (μF)	Wiameter (mm)	Length (mm)	H (mm)	Output	du/dt (v/μ0s)	Irms max. (A)	ESR (mΩ)
Un 800V Dc Us 1200VDC								
DHC-800-20-62M6	20	62	74	25	M6	70	50	1.5
DHC-800-30-62M6	30	62	74	30	M6	65	60	1.5
DHC-800-35-62M6	35	62	74	42	M6	50	60	1.6
DHC-800-40-62M6	40	62	74	42	M6	45	60	1.6
DHC-800-45-62M6	45	62	74	45	M6	45	60	1.6
DHC-800-50-62M6	50	62	74	45	M6	45	60	1.6

Part Numbering System : DHC800 -30-M6" = style "A B C D"

How to Order:

DHC - 800 - 30- 62 M6

